



# FOR LEASE

OFFICE SPACE AVAILABLE

Creskide Office Park  
1631 Creskide Dr., Suite 101  
Folsom, CA 95630



## PROPERTY HIGHLIGHTS

- Suite 101+/- 1,667SF
- Lease Rate \$2.00 - \$2.10 RSF MG
- TI Allowance negotiable
- Centrally located in Folsom's Medical District across from Dignity Health Mercy Hospital
- Direct access to Folsom Bike Trail
- Convenient access to numerous restaurants, shops and services

For more information, click [HERE](#)

Please do not disturb tenants. For more information or to arrange a tour, contact the listing agents:

**BOB KUHL**  
KW Commercial  
Cell: 916.947.5060  
[bob@bobkuhl.com](mailto:bob@bobkuhl.com)  
DRE # 00606862

**GRETCHEN TOBIN**  
KW Commercial  
Cell: 916.425.7711  
[gretchentobin@kw.com](mailto:gretchentobin@kw.com)  
DRE # 00937965

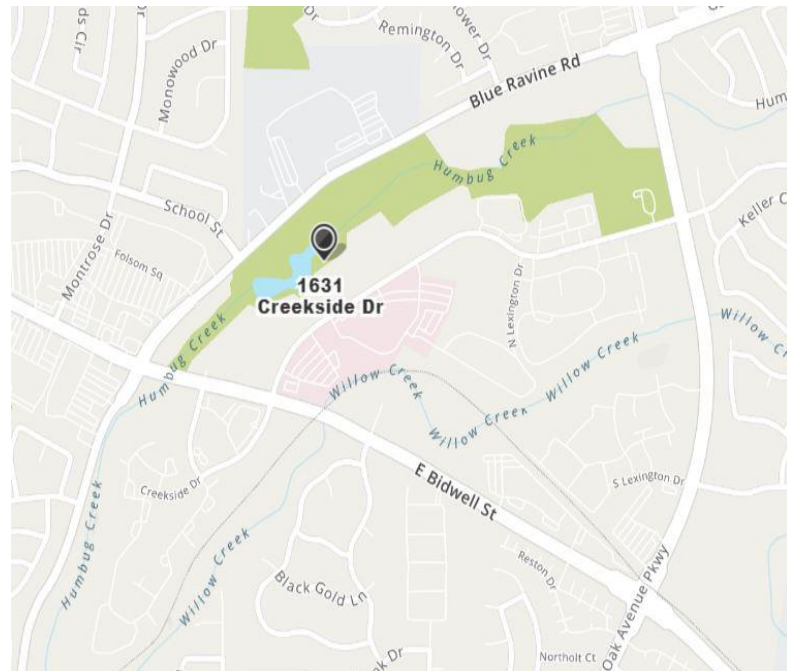

[www.bobkuhl.com](http://www.bobkuhl.com)

KW Commercial | 548 Gibson Drive, Ste 200 | Roseville, CA 95768 | 916.788.8800 | License #1272617

The information contained herein was obtained from third parties, and it has not been independently verified by the real estate brokers. Buyers/tenants should have the experts of their choice inspect the property and information. Real estate brokers are not qualified to act as or select experts with respect to legal, tax, environmental, building construction, soils-drainage or other such matters.

**Creekside Office Park**  
**1631 Creekside Dr., Suite 101**  
**Folsom, CA**

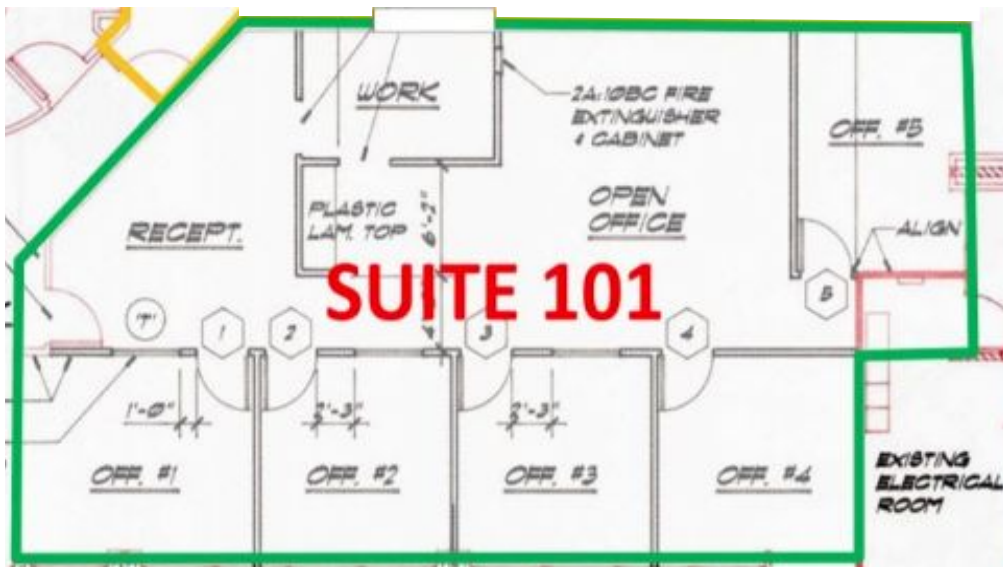

Available Units	Office SF	Lease Rate / SF
1631 Creekside Dr. Suite 101	+/- 1,667 RSF	\$2.00 - \$2.10 MG

For more information,  
 please contact:

**BOB KUHL**  
 Cell: 916.947.5060  
[bob@bobkuhl.com](mailto:bob@bobkuhl.com)  
 DRE Lic. # 00606862

**GRETCHEN TOBIN**  
 Cell: 916.425.7711  
[gretchentobin@kw.com](mailto:gretchentobin@kw.com)  
 DRE License # 00937965

[www.bobkuhl.com](http://www.bobkuhl.com)

KW Commercial | 548 Gibson Drive, Ste 200 | Roseville, CA 95768 | 916.788.8800 | License #1272617

The information contained herein was obtained from third parties, and it has not been independently verified by the real estate brokers. Buyers/tenants should have the experts of their choice inspect the property and information. Real estate brokers are not qualified to act as or select experts with respect to legal, tax, environmental, building construction, soils-drainage or other such matters.